



MP947 FOLDING ALUMINUM HAND TRUCK

ASSEMBLY INSTRUCTIONS



SPECIFICATIONS

Capacity	275 lbs. (125 kg)
Material	Aluminum alloy plate & steel tube
Overall unfolded size	1143H x 525D x 490W mm
Overall folded size	880L x 70D x 490W mm
Foot plate size	350D x 485W mm
Cable length	6.5 ft (198 cm)
Steel tube size	Ø22 mm X 1.5 mm thickness
Packing size	910L x x 80D x 510W mm (1.3 cu. ft.)/carton
Net weight	13.45 lbs. (6.1 kg)
Gross weight	14.99 lbs. (6.8 kg)

SAFETY INSTRUCTIONS

- Dispose of all packaging material as it may be harmful to children
- Do not allow children or anyone with limited physical or cognitive abilities to operate the hand truck
- Verify that all parts are in good operating condition before use
- Do not exceed load capacity (275 lbs./125 kgs)
- Do not tilt the hand truck when loading, as it may flip over
- Always drive the hand truck directly over obstacles so both wheels pass over the obstacle at the same time to avoid tilting
- Ensure the hand truck is parked on level ground to prevent accidental rolling or movement
- Do not transport humans or animals with the hand truck
- Store unit in a dry, well-ventilated place at all times
- Changing or modifying the structure will void the warranty
- Only use manufacturer replacement parts for repairs

OPENING YOUR HAND TRUCK

1. Before use, check if the nose plate or hand bar are stuck.
2. Press the lock button of the hand bar and pull upward.
3. Use your foot to press the nose plate down into position. The wheels will pop out automatically.

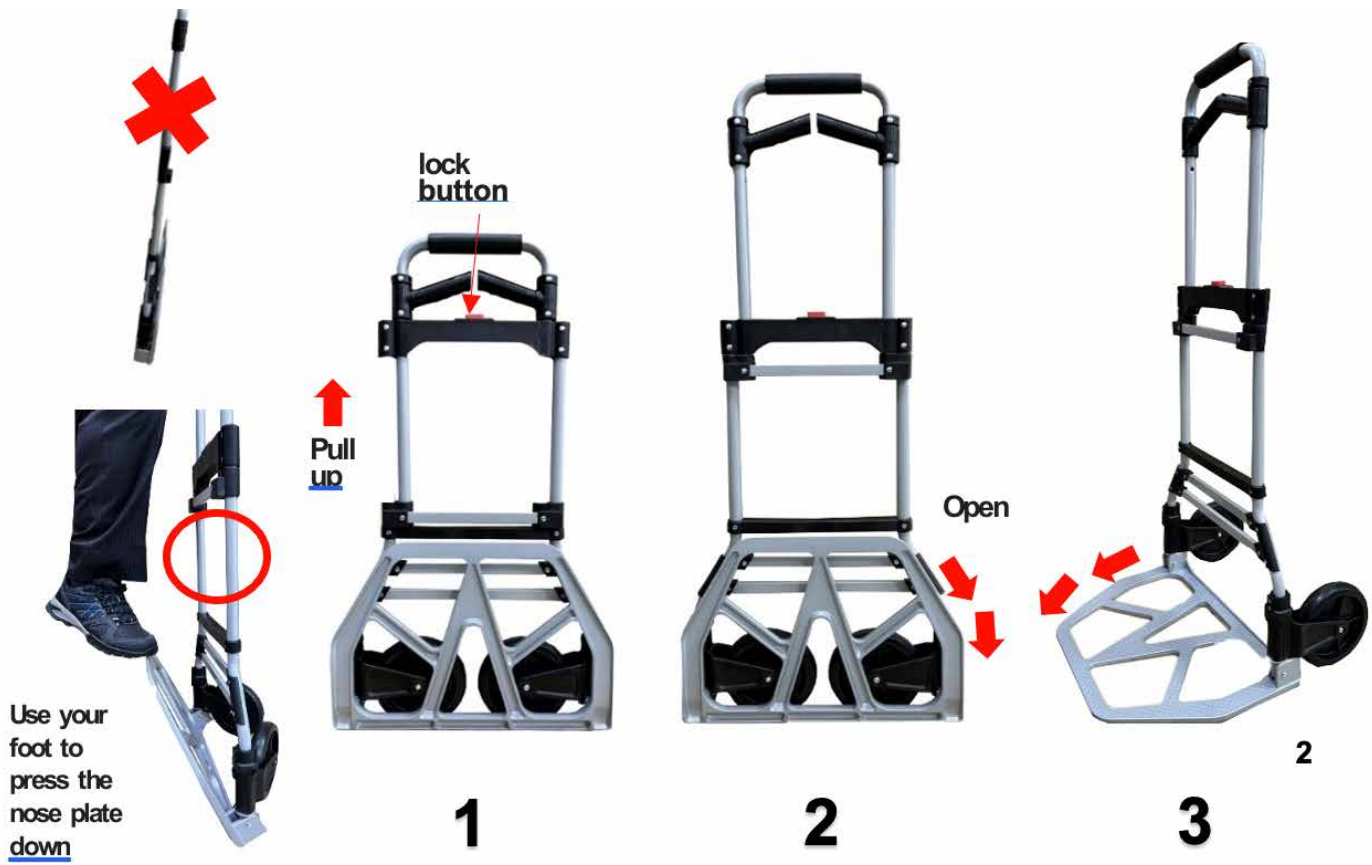

OPENING / CLOSING THE HANDLES & LOADING / MOVING THE HAND TRUCK

1. To open, raise the hand bar and move the handles outward to the appropriate position.
2. To close, position handles inward and lower the hand bar to the original position.
3. The hand truck can be loaded two ways:
 - a. For smaller loads, ensure the hand truck is securely parked with the nose plate flat on the ground. Place load on the nose plate.
 - b. For larger loads, ensure the nose plate is flat on the ground. Move the hand truck forward and slide the nose plate fully under the load.
4. To move the hand truck, put a foot on the wheel axle and tilt back to raise nose plate, then move the hand truck forward or backward, ensuring both wheels remain on the ground.



Handless opened



Handles closed



Loading and moving

CLOSING THE HAND TRUCK

1. Ensure the handles are positioned inward. Press the lock button of the hand bar, push the handle downward, and lock it in the lowest position.
2. Fold the foot plate upwards. The wheels will fold in automatically.

